

**BRAUN**



**Clean & Renew™**

Type 5301



## Braun Infoline

Deutsch	6, 33, 38
English	8, 33, 38
Français	10, 33, 38
Español	12, 34, 38
Português	14, 34, 38
Italiano	16, 35, 38
Nederlands	18, 35, 38
Dansk	20, 35, 38
Norsk	22, 35, 38
Svenska	24, 36, 38
Suomi	26, 36, 38
Türkçe	28, 38
Ελληνικά	30, 36, 38

- (D)** Haben Sie Fragen zu diesem Produkt?
- (A)** Rufen Sie an (gebührenfrei):  
**00 800 27 28 64 63**  
**00 800 BRAUNINFOLINE**
- (CH)** **08 44 - 88 40 10**
- (E)** Servicio al consumidor para España:  
**901 11 61 84**
- (P)** Serviço ao Consumidor para Portugal:  
**808 20 00 33**
- (I)** Servizio consumatori:  
**(02) 6 67 86 23**
- (NL)** Heeft u vragen over dit produkt?  
Bel Braun Consumenten-infolijn:  
**0 800-445 53 88**
- (B)** Vous avez des questions sur ce produit ?  
Appelez Braun Belgique  
**(02) 711 92 11**
- (DK)** Har du spørgsmål om produktet? Så ring  
**70 15 00 13**
- (N)** Spørsmål om dette produktet? Ring  
**22 63 00 93**
- (S)** Frågor om apparaten? Ring Kundservice  
**020 - 21 33 21**
- (FIN)** Onko Sinulla kysyttävää tuotteesta? Soita  
**0203 77877**
- (TR)** Müşteri Hizmetleri Merkezi:  
**0212 - 473 75 85**

### Internet:

[www.braun.com](http://www.braun.com)

A

3

2

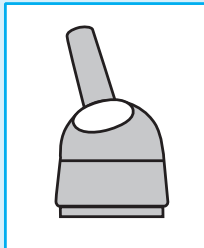

1

4

5

6

7

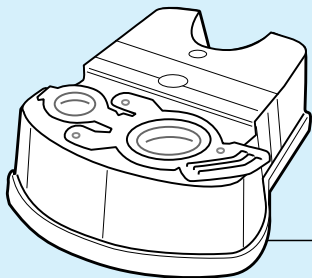
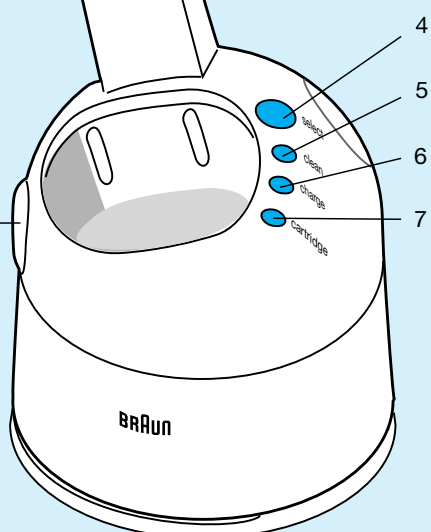

8

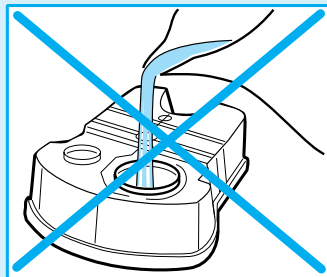

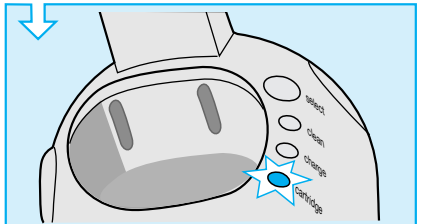
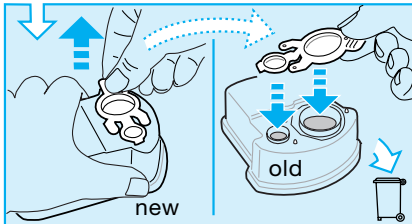
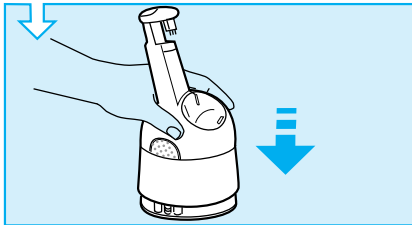
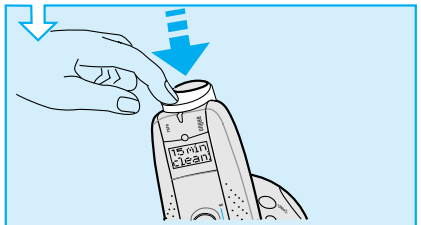
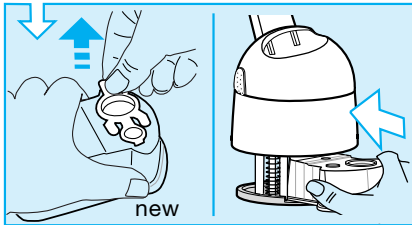
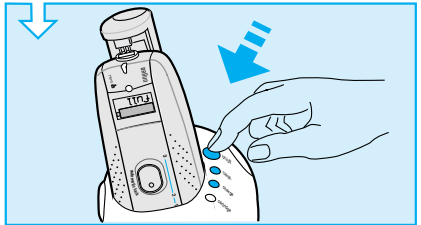
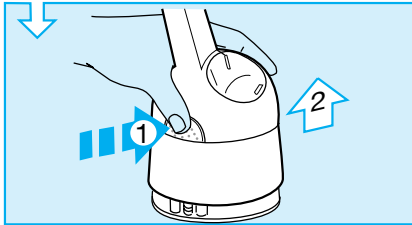
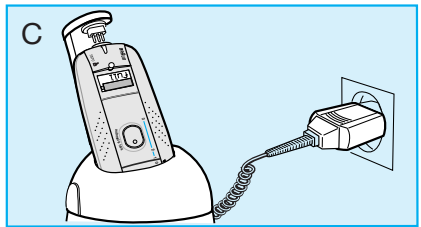
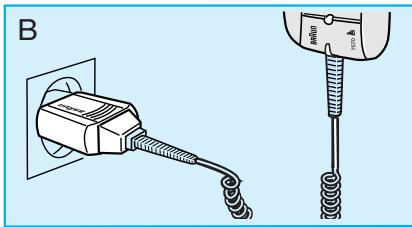

## English

Braun Clean&Renew™ has been developed for cleaning, charging and storing your shaver. Clean your shaver daily in the Clean&Renew™.

During the automated cleaning process, the shaver is switched on and off at intervals to obtain best cleaning results. Since the specially formulated cleaning fluid contains a small amount of oil, the cleaning procedure also fulfills the lubrication needs of the shaver.

### Important

- Only use the power supply cord set supplied with the shaver.
- In order to avoid any leakage of the cleaning fluid, place the appliance on a flat, stable surface or use the wall holder (not included in all versions). Do not tip, move suddenly or transport in any way if a cleaning cartridge is installed.
- Do not place the appliance in a mirror cabinet, nor store it over radiators, nor place it on polished or laquered surfaces. Do not expose to direct sunlight.
- The appliance contains highly flammable liquid. Keep it away from sources of ignition.  No smoking. Keep out of reach of children. Do not refill cartridge. Use only original Braun refill cartridge.
- When cleaning the shaver, its protection cap should be removed.

## A Description

- 1 Lift button for cartridge exchange
- 2 Contact bow
- 3 Release button
- 4 Operation mode selector
- 5 «clean» light:  
cleaning process indicator
- 6 «charge» light:  
charging process indicator
- 7 «cartridge» light:  
cartridge replacement indicator
- 8 Cleaning cartridge

### Wall holder (not included in all versions)

Mount the wall holder with plugs and screws to a smooth wall so that the standing surface for the Clean&Renew™ is horizontal.

### Technical specifications

- Power consumption:  
3 W when cleaning  
7 W when charging
- Power supply: 100-240 V ≈ /50 or 60 Hz (automatic adaptation)
- Input voltage: 12 V

## B Before using Clean&Renew™

### Only applies for cordless shavers:

For the first charge of the shaver, connect the power supply cord set directly to the shaver, charge it for 4 hours and shave at least once.

Only then can the shaver be cleaned or recharged in the Clean&Renew™.

If the rechargeable battery is discharged, select the combined «clean» + «charge» programme rather than the «clean» programme alone.

### Installing the cartridge

- Press the lift button (1) to open the housing.
- Hold the cartridge down on a flat, stable surface (e.g. table). Carefully remove the lid from the cartridge. Slide the cartridge into the base as far as it will go.
- Slowly close the housing by pushing it down until it locks.

### Replacing the cartridge

After having pressed the lift button to open the housing, wait for a few seconds before removing the used cartridge.

Before discarding the used cartridge, make sure to close the openings using the lid of the

new cartridge, since the used cartridge will contain contaminated cleaning solution.

## C Operating your Clean&Renew™

- Connect your Clean&Renew™ with the cord set to the mains electricity supply. Open the contact bow (2) by pressing the release button (3). After shaving, switch the shaver off and place it upside down into the Clean&Renew™ (without having released the shaver foil).
- Select the operation mode by toggling with the mode selector (4):  
«clean» (about 15 min)  
«clean» + «charge» (about 75 min)  
«charge» (about 60 min)  
The corresponding lights will come on. (With cord shavers, only the «clean» function can be selected.)
- Slide down the contact bow to connect the shaver and to start the selected programme. If no programme is selected, the default function «clean» will be started. (Shaver model 7570/7680/7690 only: The display shows the remaining time of the running programme in 5-minute-steps.)
- Do not interrupt a running programme, as it leaves the shaver wet and not fit for use. If interruption is needed nonetheless, press the release button.
- After a programme has finished, the corresponding light will go out. Prior to the next shave, press the release button to release the shaver.
- When the «cartridge» light starts flashing, the remaining fluid in the cartridge is sufficient for about 5 more cleaning cycles. After these 5 cycles, the cleaning performance will be reduced and the cartridge has to be replaced.
- When the «cartridge» light illuminates constantly, the cleaning function is locked

and a new cartridge has to be installed. Only then, the next cleaning cycle can be started.

- A cleaning cartridge should be sufficient for about 30 cleaning cycles. With daily use, the cleaning cartridge should be replaced approx. every 4 weeks.
- The hygienic cleaning solution cartridge contains alcohol which, once opened, will naturally evaporate slowly into the surrounding air. Each cartridge, if not used daily, should be replaced after approx. 8 weeks.
- Do not leave the appliance plugged-in without the shaver inserted.
- Clean the housing from time to time with a damp cloth, especially the opening where the shaver rests.

Subject to change without notice.

This product conforms to the EMC-Directive 89/336/EEC and to the Low Voltage Regulation 73/23 EEC.



At the end of the product's useful life, please dispose of it at appropriate collection points provided in your country.

