

Deutsch	4, 13, 15, 18
English	5, 13, 15, 18
Français	6, 13, 15, 18
Italiano	7, 13, 16, 18
Nederlands	8, 13, 16, 18
Dansk	9, 14, 16, 18
Norsk	10, 14, 17, 18
Svenska	11, 14, 17, 18
Suomi	12, 14, 17, 18

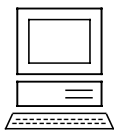

Braun Infoline

- (D) Haben Sie Fragen zu diesem Produkt?  
Rufen Sie an: (in Deutschland und Österreich zum Nulltarif)  
00 800 27 28 64 63  
00 800 BRAUNINFOLINE
- (A) 08 44 -88 40 10
- (CH) Heeft u vragen over dit produkt?  
Bel.  
Braun Consumenten-infolijn:  
(070) 4 13 16 58
- (NL) Vous avez des questions sur ce produit?  
Appelez Braun Belgique  
(02) 718 29 09
- (DK) Har du spørgsmål om produktet?  
Så ring  
39 55 8133
- (N) Spørsmål om dette produktet?  
Ring  
22 9170 10
- (S) Frågor om apparaten?  
Ring Kundservice  
031- 89 06 50
- (FIN) Onko Sinulla kysyttävää tuotteesta? Soita  
(09) 452 8735



Internet:  
www.braun.com  
www.oralb.com

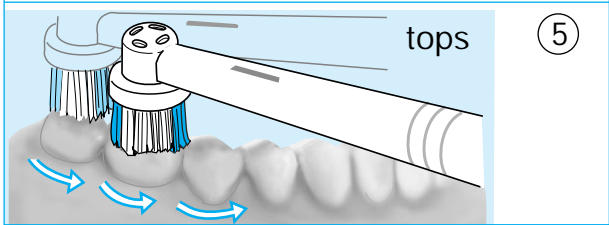
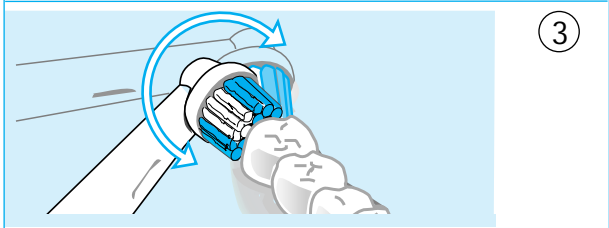
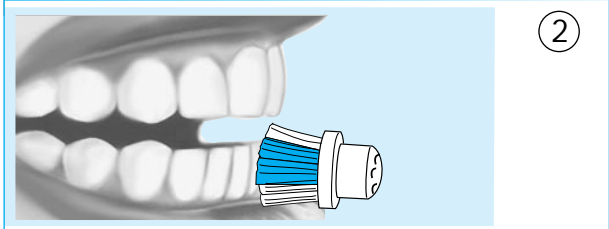
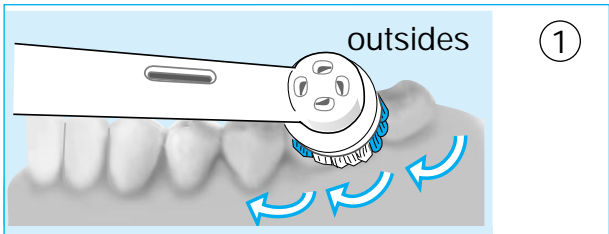
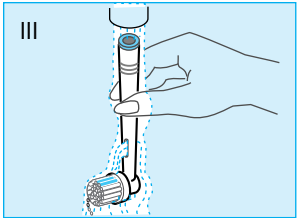
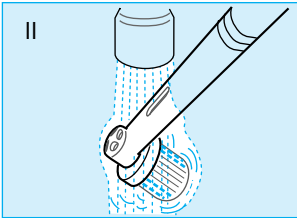
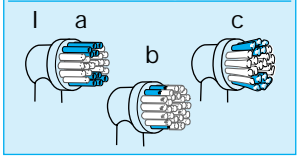
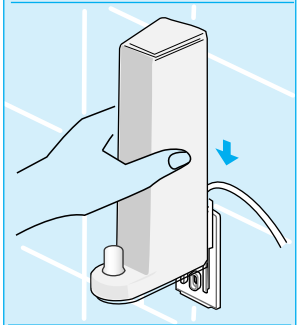
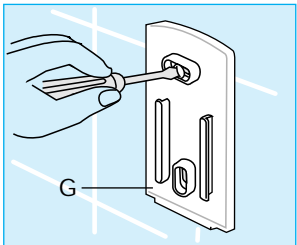
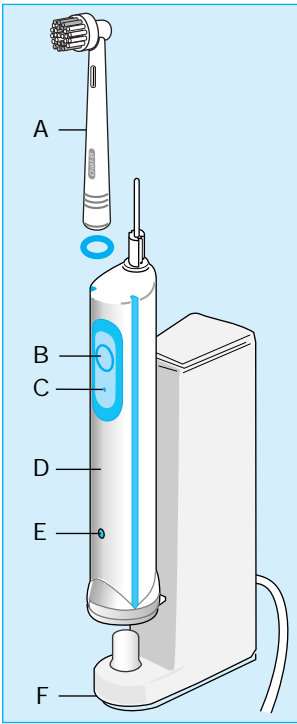

# English

The Braun Oral-B Plak Control Ultra has been developed together with leading dental professionals to effectively remove plaque from all areas of your teeth. It has been designed for daily use for the whole family.

Please read the use instructions carefully before first use.

## Important

Periodically check the cord for damage. Should this be the case, take the charging unit (F) to a Braun Service Centre. A damaged or non-functioning unit should no longer be used.

## Description

- A Brushhead
- B On switch
- C Off switch
- D Handle
- E Charge indicator
- F Charging unit
- G Wall holder

## Specifications

Power supply: see bottom of charging unit  
Handle voltage: 2.4 V

## Connecting and charging

The plaque remover is electrically safe and can be used in the bathroom without hesitation.

- Plug the charging unit into an electrical outlet. Place the handle on the charging unit. The charge indicator will light up.
- A full charge takes 16 hours and will provide an operation time of approx. 30 minutes.
- For everyday use, the handle can be stored on the plugged-in charging unit to maintain the plaque remover at full power. Overcharging is impossible.

## Battery maintenance

To maintain the maximum capacity of the rechargeable battery, unplug the charging unit and discharge the handle by regular use at least every 6 months.

## Using the plaque remover

The plaque remover can be used with any leading brand of toothpaste. However, we do not recommend toothpastes with whitening agents.

- To avoid splashing, guide the brushhead to your teeth before switching the appliance on.
- Slowly guide the brushhead from tooth to tooth, spending a few seconds on each tooth surface.
- Brush the gums as well as the teeth, first the outsides, then the insides and finally the chewing surfaces.
- Do not press too hard or scrub, simply let the brush do all the work.
- To thoroughly remove plaque, brush for at least two minutes.

## Timer

(not with all models)

An incorporated timer memorises the elapsed brushing time. After two minutes the timer signals by a short stutter.



During the first days of using the plaque remover, your gums may bleed slightly. In general, bleeding should stop after a few days. Should it persist after two weeks, please consult your dentist or hygienist.

Dentists recommend that you replace any toothbrush every 3 months, since worn bristles do not remove plaque as effectively as new ones. Therefore, the brush-head is provided with INDICATOR® bristles (I.a). With proper brushing twice a day for two minutes, the colour will disappear half-way down the bristles in a 3-month period, provided you use toothpaste (I.b).

If the bristles splay before the colour recedes (I.c), you are exerting too much pressure on teeth and gums.

## Replacement brushheads

This product can be used with all Braun Oral-B Plak Control / Plaque Remover brushheads.

## Cleaning

After use, rinse the brushhead for several seconds under running water with the handle switched on (II). Then switch off the handle and take off the brushhead. Rinse both parts separately under running water (III) and wipe them dry.

From time to time, also clean the charging unit with a damp cloth.

For cleaning purposes, the brush-head compartment (not with all models) is removable.

## Environmental notice

This product contains nickel-cadmium rechargeable batteries. In the interest of protecting the environment, do not dispose of the product in the household waste at the end of its useful life. Disposal can take place at a Braun Service Centre.



However, if you prefer to dispose of the battery yourself, please refer to the section «Battery removal».

Subject to change without notice.

This product conforms to the EMC-Requirements as laid down by the Council Directive 89/336/EEC and to the Low Voltage Regulation (73/23 EEC).

