

Age Range: 3-7 Yrs.
 Weight Limit: 65 Lbs.
 Surfaces: Hard, Grass & Hills
 Speed: 2.5 / 5.0 MPH Forward
 2.5 MPH Reverse
 Colors: White Body
 Blue & Green Trim
 Avail: 2-1-95 - 1997
 Suggested Retail: \$189.99
 Box Dimensions: 24-1/2" x 29-1/2" x 52-1/2"
 Warranty: 90 Days Vehicle
 6 Months Battery

74590-9993 KAWASAKI NINJA ATV

Advanced Series
 12-VOLT

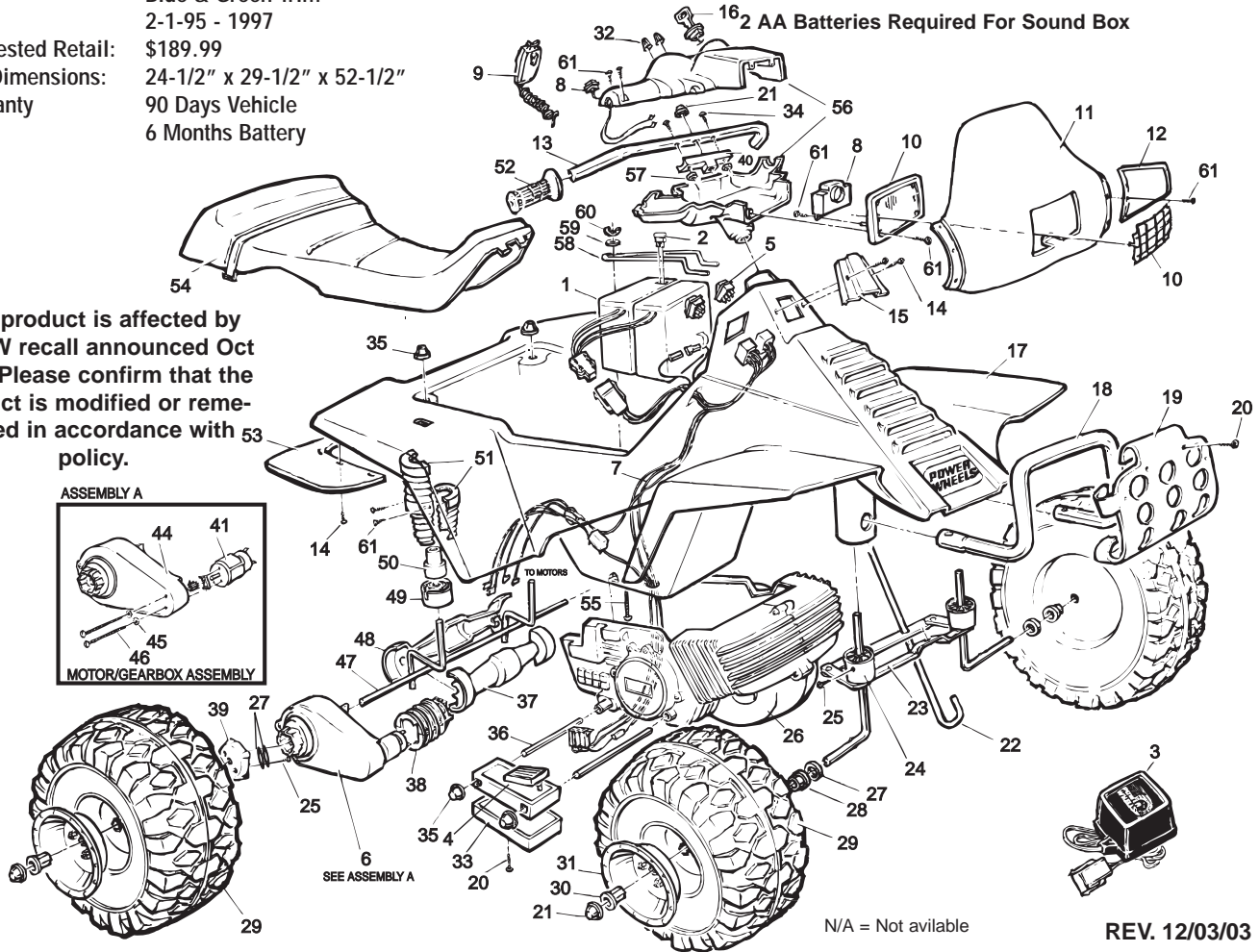

This product is affected by the PW recall announced Oct 1998. Please confirm that the product is modified or remediated in accordance with 53 policy.

REV. 12/03/03

Item No.	Description	Part No.	Qty.	Item No.	Description	Part No.	Qty.	Item No.	Description	Part No.	Qty.
1	Battery	00801-0712	2	27	7/16" Washer	0801-0196	6	55	Carriage Bolt N/A	0801-0305	1
2	30 Amp Fuse N/A	0801-0229	2	28	Axle Bushing	74550-2689	2		(Order Hardware Bag) N/A	78475-9259A	
3	Charge	00801-0973	1	29	Wheel	78570-2469	4	56	Headlight Housing Set N/A	74590-2149	1
4	<u>Footswitch Assembly</u>	<u>74110-9169</u>	1	30	Hex Bushing	73233-2559	4	57	Lock Nut N/A	0801-0318	2
5	Control Switch	00801-0885	2	31	Hubcap	74590-2579	4	58	Battery Retainer	76262-4489	1
6	Motor/Gearbox Assembly	74110-9519	2	32	Radio Knobs N/A	78570-2179	2	59	#10 Washer N/A	0801-0195	1
7	<u>Main Wiring Harness</u>	<u>76816-9799</u>	1	33	Bottom Cover Footboard N/A	74590-2759	1	60	Wing Nut N/A	0801-0317	1
8	Sound/Switch Assy. N/A	74590-9549	1	34	#10 x 1-1/2" Phillips Screw N/A	76222-4459	2	61	#6 x 1/2" Screw	0801-0280	22
9	Microphone	73233-9479	1	35	.354 Cap Nut	0801-0604	6	PARTS NOT SHOWN			
10	Headlight Rim/Guard N/A	74590-2179A	1	36	Footboard Support Rod	76262-4439	2		Power Wheels Emblem Set	74460-9069	1
11	Windshield N/A	76816-2729	1	37	Rear Axle Cover (inside) N/A	74590-2139	1		Decal (main decal w/out windshield) N/A	74590-0340	1
12	Handgrip Guard Set N/A	74590-2199	1	38	Motor Cover	*74750-2359	2		**Main Decal Sheet (with windshield N/A	74590-0350	1
13	Handlebar N/A	76816-4229	1	39	Driver	73233-2239	2		Footrest, Left N/A	74590-2129	1
14	#8 x 1/2" Phillips Screw	0801-0202	10	40	Handlebar Neck	76816-4289	1		Literature Bag N/A	74590-9029	1
15	Cover Plate N/A	74590-2169	1	41	<u>Motor w/Pinion</u>	<u>74590-9539</u>	2		Large Parts Bag #1 N/A	74590-9249	1
16	Key Housing N/A	74550-2439	1	44	<u>Gearbox</u>	<u>74550-9279</u>	2		Large Parts Bag #2 N/A	74590-9259	1
17	Body N/A	74590-2109	1	45	<u>Star Washer N/A</u>	<u>0801-0330</u>	4		Small Parts Bag (N/A)	74590-9229A	1
18	Roll Bar N/A	74590-9419	1	46	<u>Motor Bolts</u>	<u>0801-0269</u>	4		(Can sub 74750-9259 Small parts bag but must also send (14) 0801-0280 #6 x 1/2" screws & (3) #73233-2559 bushings.)		
19	Brushguard N/A	74590-2189	1	47	Rear Axle N/A	76816-4539	1		Gearbox Insert N/A	76108-2259	2
20	#8 x 3/4" Screw	0801-0223	6	48	Rear Axle Cover (Outside) N/A	74590-2119	1		<u>Bold and Underlined parts are to be purchased and installed by Service Centers only. These items may not be sold directly to consumers by Service Centers or Fisher-Price.</u>		
21	.437 Cap Nut	0801-0226	5	49	Rear Post Bushing N/A	74590-2539	2				
22	Steering Column N/A	76816-4249	1	50	Rear Bushing w/Extension N/A	74557-2669	2				
23	Steering Linkage N/A	74750-9239	1	51	Shock Set N/A	74590-2089	2				
24	Front Post Bushing N/A	74590-2549	2	52	Handgrip N/A	78570-2219	2				
25	#10 x 1/2" Screw	0801-0255	4	53	Mudflap Set N/A	74590-2219	1				
26	False Motor N/A	74590-2069	1	54	Seat	74590-2309	1				

**Seperate windshield decal has been incorporated into new main decal 74590-0350.