

Age Range: 1-1/2 to 4 Yrs.
 Weight Limit: 50 Lbs.
 Surfaces: Hard
 Speed: 2.5 MPH Forward
 Colors: Bright Pink Body
 White Wheels & Seat
 Aqua & Purple Detail

Service Bulletin 157 and
 Service Bulletin 154

74518-9993 Surf 'n Fun (w/Handle)

Preschool Series
 6 Volt

Intro:
 Suggested Retail: \$99.99
 Warranty

1 year bumper to bumper
 6 Months Battery

TRU Exclusive

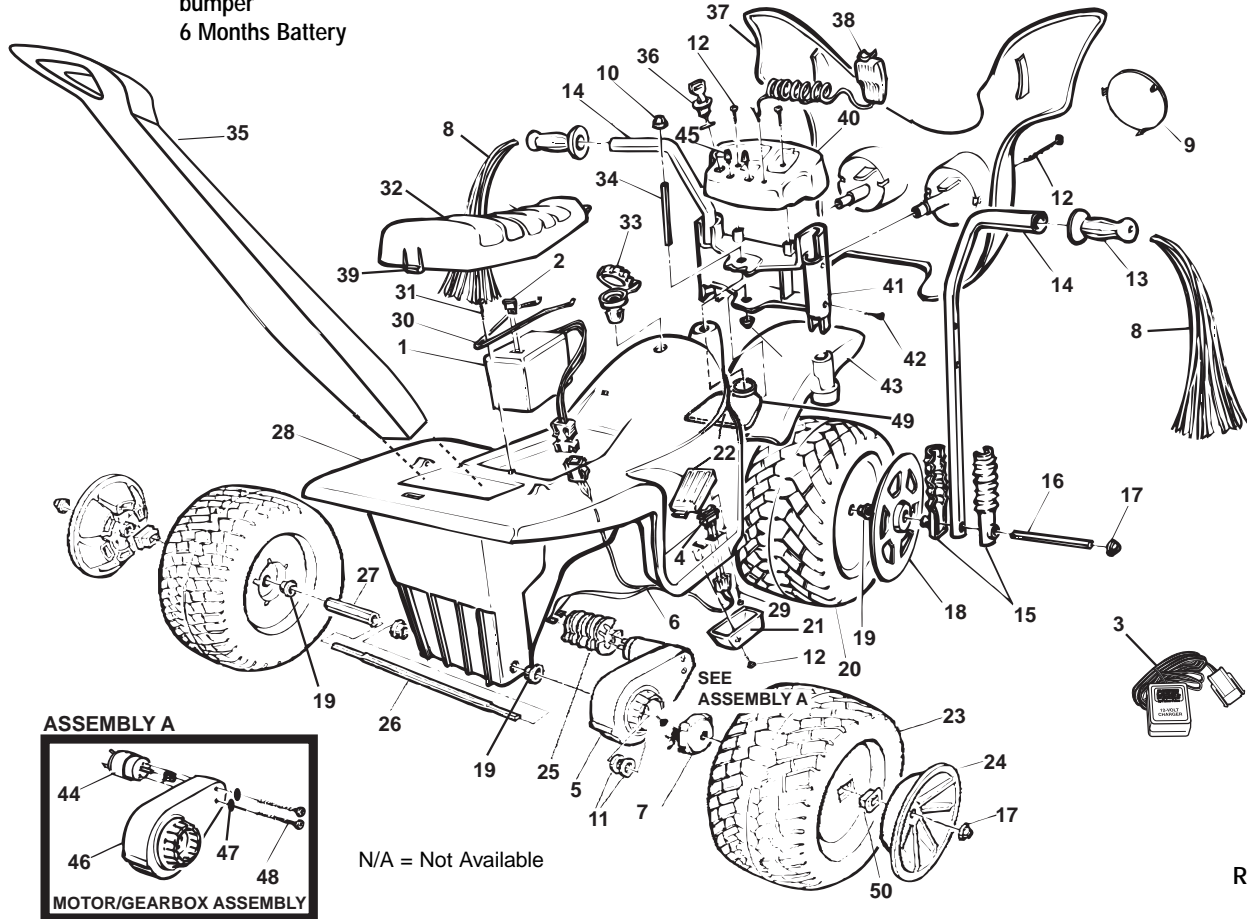

Rev. 11/21/03

Item No.	Description	Part No.	Qty.	Item No.	Description	Part No.	Qty.	Item No.	Description	Part No.	Qty.
1	Battery	00801-1234	1	24	Rear Hubcap N/A	74517-2589	2	46	3a Gearbox w/out Motor	74580-9269	1
2	25 amp Fuse	0801-0151	1	25	Motor Cover	74750-2359	1	47	Star Washer N/A	0801-0330	2
3	6 Volt Charger	00801-0975	1	26	Rear Axle	74510-4549	1	48	Motor Bolt	0801-0269	2
4	*Foot Switch	0801-0538	1	27	Axle Spacer Tube N/A	74510-4449	1	49	Flex Plate N/A	74510-2159	1
5	3a Motor/Gearbox Assm	74780-9509	1	28	Body (N/A)	74518-9159	1	50	Rectangular Bushing	74550-2689	2
6	Wiring Harness N/A	78410-9799	1	29	#8 x 1" Screw N/A	0801-0273	1	PARTS NOT SHOWN			
7	Driver N/A	77410-2239	1	30	Battery Retainer	74510-4439	1	#6 - 20 x 1" Screw for Swivel Bracket	0801-0254	1	
8	Handlebar Streamers N/A	78470-2139	2	31	7/8" Screw	0801-0228	1	1-1/4" Flex Plate Scr N/A	0801-0216	2	
9	Headlight Lens Set N/A	74517-215A	1	32	Seat w/Lock	74280-230A	1	Literature Bag N/A	74518-9019	1	
10	.354 Cap Nut	0801-0548	2	33	Gas Cap N/A	74517-2179	1	Adhesive Harness Clip	0801-0313	1	
11	7/16" Washer	0801-0196	2	34	Pivot Pin N/A	74510-4429	1	Prismatic Label Sheet N/A	74517-0330	1	
12	#8 x 1-1/2" Screw	0801-0308	4	35	Handle (Assist) N/A	74518-2199	1	Paper Label Sheet N/A	74517-0340	1	
13	Handgrip N/A	74517-2169	2	36	Key Assembly	78490-9369	1	Main Label Sheet N/A	74517-0320	1	
14	Handlebar Set N/A	74850-442A	1	37	Fairing N/A	74517-272A	1	Owner's Manual N/A	74518-0920	1	
15	Shock Set N/A	74517-9089	1	38	Microphone N/A	74780-9489	1	Large Parts Bag N/A	74518-9249	1	
16	Front Axle	74510-4519	1	39	Lock Fastener (when depleted, use new 74517-2439)	77571-2239	1	Small Parts Bag N/A	74518-9259	1	
17	.437 Cap Nut	0801-0227	4	40	Dash N/A	74517-2699	1	Hardware Bag N/A	74518-9259A	1	
18	Front Hubcap N/A	74517-2579	2	41	Swivel Bracket N/A	74850-2129	1	Handlebar Plug N/A	74510-2169	2	
19	Wheel Bushing	74550-2689	3	42	3/4" Screw	0801-0223	4				
20	Front Wheel N/A	78470-2469	1	43	Fender N/A	74517-2249	1				
21	Footboard Cover N/A	77410-2159	1	44	Motor w/Pinion	74590-9539	1				
22	Ft Pedal w/SpringClip N/A	74517-9429	1	45	Radio Knobs N/A	78570-2179	2				
23	Rear Wheel N/A	78470-2459	2								

* See Service Bulletin 157 and 154.

Bold and Underlined parts are to be purchased and installed by Service Centers only. These items may not be sold directly to consumers by Service Centers or Fisher-Price.

