

Age Range: 3-7 Yrs.
 Weight Limit: 90 Lbs.
 Surfaces: All
 Speed: 2.5 / 5.0
 Forward

Colors: 2.5 Reverse
 Yellow Body
 Black Wheels
 Black & Blue

Trim Intro: 1989

This product is affected by the PW recall announced Oct 1998. Please confirm that the product is modified or remediated in accordance with policy.

73249-9993 / 86500

SUZUKI® QUAD RACER

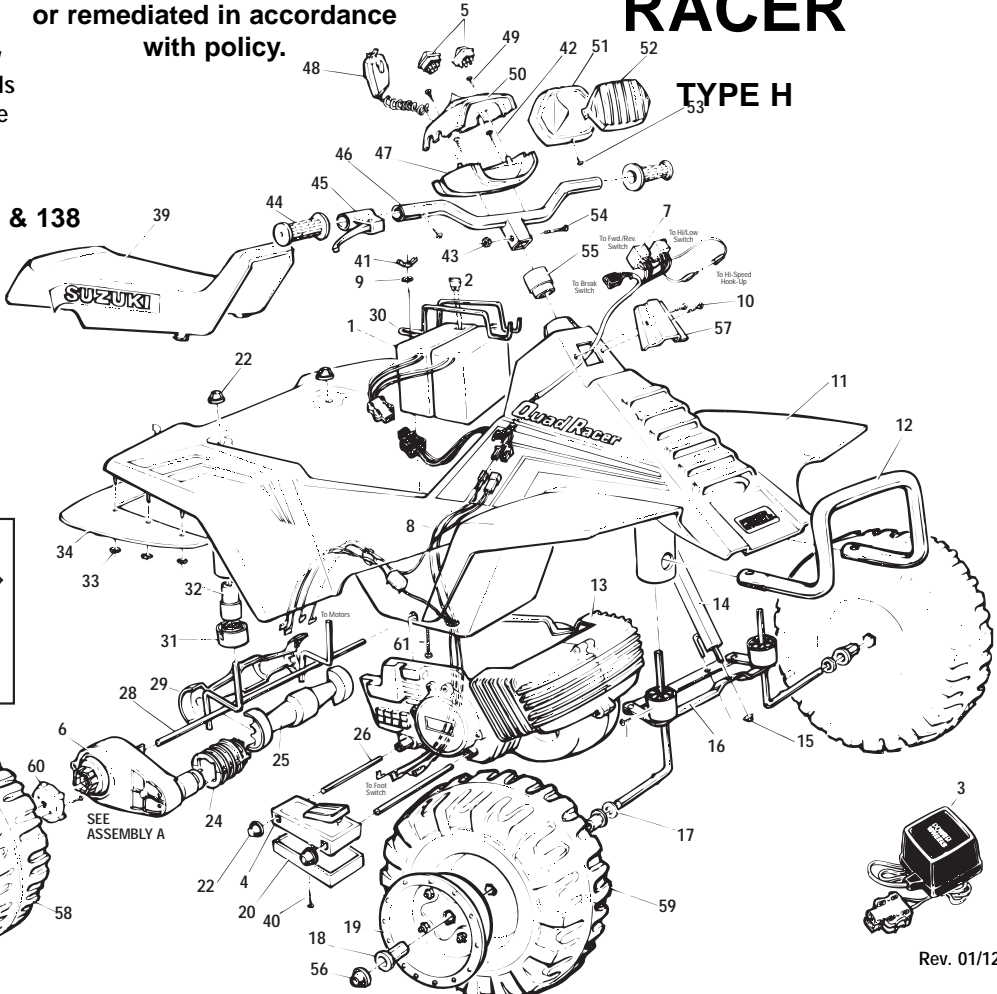

Rev. 01/12/04

Item No.	Description	Part No.	Qty.	Item No.	Description	Part No.	Qty.	Item No.	Description	Part No.	Qty.
1	**Battery (Type H)	00801-0712	2	24	Motor Cover	74750-2359	2	47	Headlight Half/Lower (N/A)	80030-0004	1
2	<u>30-amp Fuse Kit (N/A)</u>	0801-0229	2	25	Axle Cover/Inside (N/A)	76115-2159	2	48	Microphone	73233-9479	1
3	**12 Volt Charger	00801-0973	1	26	Footboard Support Rod	76262-4439	2	49	#8 x 1" Plastilock Screw (N/A)	0801-0224	2
4	***Footswitch Assy.	76108-9159	1	27	3A Gearbox	74580-9269	2	50	Headlight Half/Upper (N/A)	80030-0139	1
5	**Control Switch	80014-0073	2	28	Rear Axle (N/A)	76816-4539	1	51	Headlight Rim	N/A	1
6	3A Motor/Gearbox Assy.	74780-9509	2	29	Axle Cover/Outside (N/A)	80046-0138	1	52	Headlight Lens	N/A	1
7	**Wiring Harness (Upper)	(N/A)	1	30	Battery Retainer	76262-4489	1	53	1/2" Plascrow	0801-0222	4
8	Wiring Harness (Lower) (N/A)	80064-0013	1	31	Post Bushing (substitut part) (N/A)	73233-2549	2	54	1" Bolt (N/A)	76262-4459	1
9	#10 Washer (N/A)	76822-4409	1	32	Bushing w/Extension (N/A)	76262-2549	2	55	Steering Column Bushing	75560-2259	1
10	#8 x 1/2" Phillips Pan Screw	0801-0202	2	33	Retainer w/o Body (N/A)	78480-2249	8	56	.437 Cap Nut	0801-0226	4
11	Body (N/A)	80005-0012	1	34	Mud Set (Yellow) (N/A)	74590-2219	1	57	Cover Plate (N/A)	74590-2169	1
12	Roll Bar (N/A)	80049-0035	1	35	Motor Drive Gear	74550-2269	2	58	Wheel/Rear (N/A)	76188-2459	2
13	False Motor sub to Ninja part (N/A)	74590-2069	1	36	Star Washer (N/A)	0801-0330	4	59	Wheel/Front (N/A)	76266-2459	2
14	Steering Column (N/A)	80054-0068	1	37	Motor Bolts	0801-0269	4	60	Drive	73233-2239	2
15	Hat Cap (N/A)	76262-4429	1	38	D-Lock Washer	0801-0329	2	61	Carriage Bolt (N/A)	0801-0305	1
16	Steering Linkage (N/A)	80055-0125	1	39	Seat (Blue) (N/A)	75560-2819	1		(Order Hardware Bag) (N/A)	78475-9259A	
17	Washer 7/16"	0801-0196	2	40	#8 x 7/8" Plascrow (N/A)	0801-0224	1	PARTS NOT SHOWN			
18	Hex Bushing	73233-2559	6	41	Wing Nut (N/A)	0801-0317	1		Footrest/Left (N/A)	76108-2179	1
19	Hubcap/Front (N/A)	80033-0027	2	42	#10 x 1/2" Screw	0801-0255	7		Handlebar Assy. w/Harness (N/A)	80029-0005	1
20	*Bottom Cover/Ftswitch (N/A)	76108-2169	1	43	10-32 Lock Nut (N/A)	0801-0318	1		Literature Bag (N/A)	80044-0131	1
21	Motor w/Pinion (N/A)	75520-9539	2	44	Handgrip (Yellow)	74504-2219	2		Decal Sheet (N/A)	80017-0417	1
22	.354 Cap Nut (Black)	0801-0604	6	45	Brake Assy. (N/A)	80011-0002	1		Use & Care Manual (N/A)	73249-CCCC	1
23	Hubcap/Rear (N/A)	80033-0028	2	46	Handlebar (N/A)	80029-0034	1				

*Cover is only available for products produced in 1994 or after.

** See Service Bulletin 138

*** See Service Bulletin 132

N/A = Not Available



Bold and Underlined parts are to be purchased and installed by Service Centers only. These items may not be sold directly to consumers by Service Centers or Fisher-Price.